

Thick Wall RFI - (1594 RFI Series)

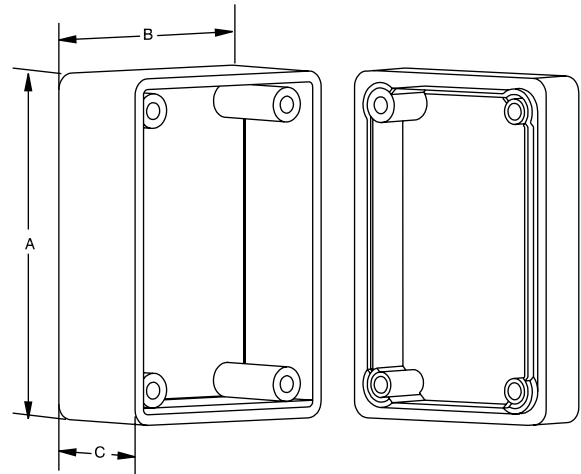
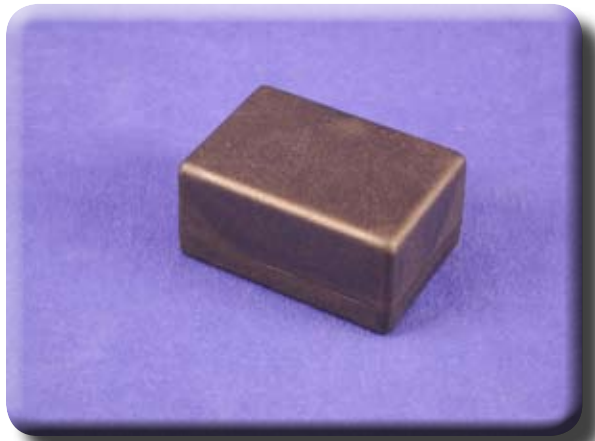

KEY FEATURES

- Designed for EMI/RFI shielding applications - using conductive plastic (a compound of plastic and stainless steel fibers).
- Electronic instrument enclosures, ideally suited for mounting printed circuit boards.
- Thick wall design with an average wall thickness of .13" (3.3 mm).
- Molded from a compound of stainless steel fibers and flame retardant ABS plastic (carries a UL flammability rating of 94V-0).
- Designed to meet IP54.
- Countersunk lid is secured with four M3 x 0.5 - 0.71" (18 mm) long, Philips machine screws threaded into integrated brass bushings. Perfect for applications where repetitive assembly and disassembly are required.
- Black with matte textured finish.
- Material is brittle - acts like phenolic - NOT FOR HIGH IMPACT USE.
- Add 0.47" (12 mm) to enclosure depth for lid.

Part Number	Color	Units	Dimensions		
			A Length	B Width	C Depth
1594RFIABK	Black	inch mm	2.2 56	2.2 56	1.1 28
1594RFIBBK	Black	inch mm	3.2 81	2.2 56	1.1 28
1594RFICBK	Black	inch mm	4.1 105	2.6 66	1.3 33
1594RFIDBK	Black	inch mm	5.2 131	2.6 66	1.7 43
1594RFIEBK	Black	inch mm	6.6 167	4.2 107	2.1 53

SAFETY NOTES:

- Conductive plastic is NOT an insulator. These enclosures must be treated like a metal enclosure.
- Conductive plastic will act as a heating element - any significant current flow will cause the plastic to heat and produce smoke.



CANADA
Guelph, Ontario (519) 822-2960
St. Laurent, Quebec (514) 343-9010
USA
Cheektowaga, NY (716) 630-7030

www.hammondmfg.com

EUROPE
Basingstoke, UK 01256 812812

AUSTRALIA
Queenstown, Australia 61-8-8240-2244